



FOR IMMEDIATE RELEASE

Thursday, August 11, 2022

Media Contacts:

German Vigil – (202) 306-1668, german.vigil@dc.gov

Mariam Nabizad – (202) 359-2678, mariam.nabizad@dc.gov

South Capitol Street Corridor Project - Weekly Closures August 15 through August 22, 2022

(Washington, DC) – The District Department of Transportation (DDOT) will temporarily close roadways, lanes, ramps and shoulders on the following corridors to perform construction activities along I-295 / DC 295 and nearby local roads. These closures are contingent on suitable weather, field conditions, and/or adjacent construction activities. Daily closures will take place between 9:30 a.m. and 3:30 p.m. Nightly closures will take place between 9:00 p.m. and 5:00 a.m. the following day (unless otherwise stated below).

Due to the scheduled events at Nationals Park and Audi Field, lane closures will not occur during the following times:

- Monday, August 15 – 5:00 p.m. to 12:00 a.m.
- Tuesday, August 16 – 5:00 p.m. to 12:00 a.m.
- Wednesday, August 17 – 11:00 a.m. to 6:00 p.m.
- Saturday, August 20 – 5:30 p.m. to 11:30 p.m.

If any of these events are cancelled, lane closures will occur during the typical times. Additionally, any nighttime full roadway closures that are prohibited on these event days will take place in the event of an event cancellation.

Single left or right lane closures will occur anytime daily and nightly during off-peak periods on northbound and southbound I-295 between the merge from Malcolm X Avenue and I-695.

Single left or right lane closures will occur daily and nightly in both directions on South Capitol Street SE/SW between Firth Sterling Avenue SE and N Street SE. Single lane closures will take place during weekday off-peak hours.

Single left or right lane closures will occur daily and nightly in both directions Suitland Parkway SE between the Martin Luther King, Jr. Avenue SE overpass and South Capitol Street SE. These single lane closures along these roadways will take place during off-peak hours.

No other closures on South Capitol Street SE/SW or Suitland Parkway SE will take place on weekdays between 5:00 a.m. and 9:30 a.m. and between 3:30 p.m. and 9:00 p.m.

Daily and nightly single lane closures will also occur during off-peak hours on Firth Sterling Avenue SE, Howard Road SE, Potomac Avenue SE/SW, Half Street SW, P Street SW, Q Street SW, and R Street SW, St. Elizabeths Road SE, and Barry Road SE.

Northbound South Capitol St SE/SW will be closed between the Firth Sterling Avenue SE intersection and the East Oval. Closures will occur nightly from 9:00 p.m. to 5:00 a.m. the following morning on Monday, Tuesday, and Friday nights, August 15, 16, and 19. Northbound South Capitol Street will also be closed between 5:00 a.m. and 5:00 p.m. on Saturday, August 20. When South Capitol Street SE/SW is closed, all lanes will remain open on Firth Sterling Avenue SE, Howard Road SE, and Suitland Parkway. Marked detours will be in place during these closures.

Northbound South Capitol Street SE/SW Closure and Detour



Eastbound Suitland Parkway will be temporarily closed from the intersection with South Capitol Street to the intersection with Firth Sterling Avenue on Friday night, August 19 from 9:00 p.m. to 5:00 p.m. the following afternoon. Ramp traffic from I-295 northbound to Suitland Parkway and South Capitol Street will be detoured to the MLK Avenue SE interchange. When Suitland Parkway is closed, all lanes will remain open on Firth Sterling Avenue SE, Howard Road SE, and southbound South Capitol Street (between the East Oval and Firth Sterling Avenue). All sidewalks will remain open during the roadway closure. Marked detours will be in place during these closures.

Eastbound Suitland Parkway Closure and Detour

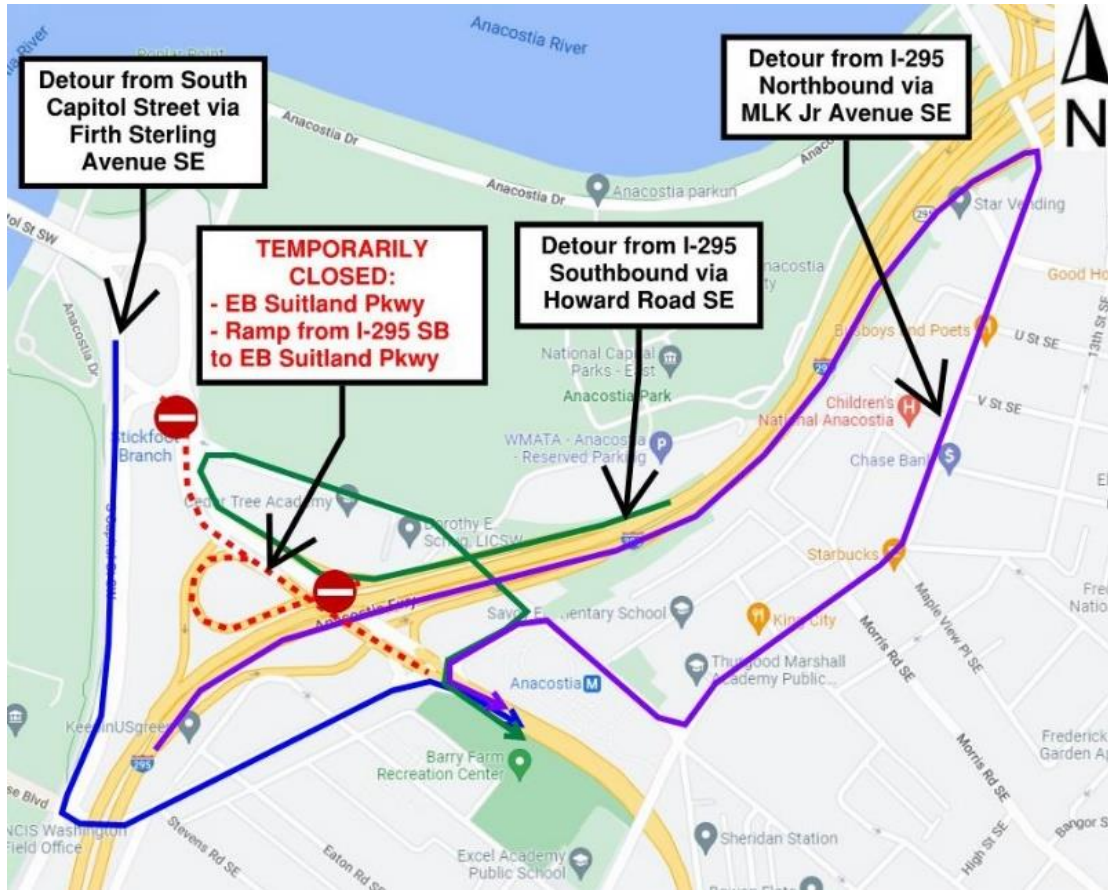

The intersection of Suitland Parkway and Firth Sterling Avenue SE will be closed nightly from 9:00 p.m. to 5:00 a.m. the following morning starting Wednesday night, August 17, extending through Saturday, August 20. Ramp traffic from I-295 northbound to Suitland Parkway will be detoured to the MLK Avenue SE interchange. When Suitland Parkway is closed, all lanes will remain open on Howard Road SE, and South Capitol Street (between Firth Sterling Avenue and Suitland Parkway). All sidewalks will remain open during the roadway closure. Marked detours will be in place during these closures.

Suitland Parkway/Firth Sterling Avenue SE Intersection Closure and Detour



Howard Road SE will be closed between Suitland Parkway and the DC Mental Health facility on Saturday, August 20 between 5:00 a.m. and 6:00 p.m. When Howard Road SE is closed, all lanes will remain open on Suitland Parkway and South Capitol Street (between Firth Sterling Avenue and Suitland Parkway). All sidewalks will remain open during the roadway closure. Marked detours will be in place during this closure.

Howard Road SE Closure and Detour

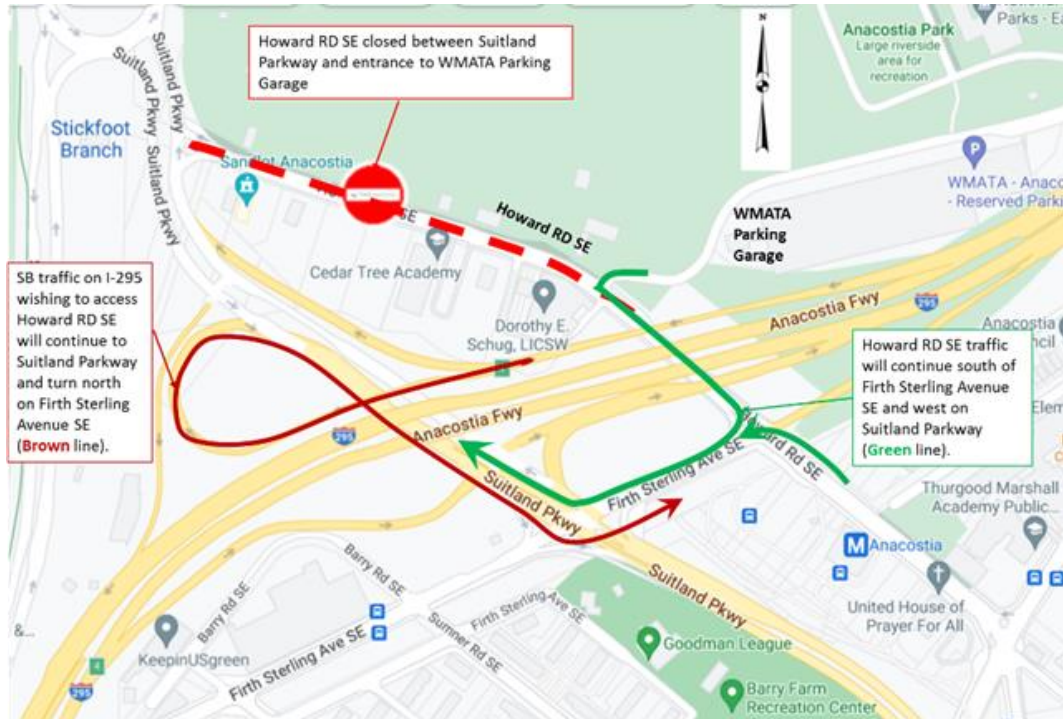

These closures are required for construction activities associated with the following DDOT projects:

South Capitol Street Corridor Project - Frederick Douglass Memorial Bridge

The South Capitol Street Corridor Project calls for replacing the Frederick Douglass Memorial Bridge and transforming related sections of the urban freeway into a beautiful scenic boulevard that increases pedestrian and vehicular safety, improves multimodal transportation options, increases community accessibility, and supports economic development on both sides of the Anacostia River.

Traffic controls will be in place to guide all users of the roadway through the work zones safely. Motorists should expect delays due to the lane closures and are advised to stay alert and be observant of signage and road work crews while traveling in this area.

For more information about the Frederick Douglass Memorial Bridge Project and to stay up-to-date on traffic related impacts and construction progress, please visit www.newfrederickdouglassbridge.com.

###

The mission of the District Department of Transportation (DDOT) is to enhance the quality of life for

District residents and visitors by ensuring that people, goods, and information move efficiently and safely with minimal adverse impact on residents and the environment.

Follow us on [Twitter](#); like us on [Facebook](#) and visit the website at www.ddot.dc.gov to find out about DDOT's work across all eight wards of the District.. Visit goDCgo.com for more information on transportation options in the District.