



FOR IMMEDIATE RELEASE

Friday, September 16, 2022

Media Contacts:

German Vigil – (202) 306-1668, german.vigil@dc.gov

Mariam Nabizad – (202) 359-2678, mariam.nabizad@dc.gov

Temporary Closures of Howard Road SE and Firth Sterling Avenue SE September 19 through September 26, 2022

(Washington, DC) - The District Department of Transportation (DDOT) will temporarily close eastbound and westbound Howard Road SE between Suitland Parkway and the DC Mental Health facility during overnight hours Monday night, September 19 through Friday morning, September 23, between 9:00 p.m. and 5:00 a.m. the following morning. When Howard Road SE is closed, all lanes will remain open on Suitland Parkway and South Capitol Street (between Firth Sterling Avenue and Suitland Parkway). Access to all businesses on this section of Howard Road SE will be maintained, as well as access to the WMATA parking facility north of Howard Road SE. All sidewalks will remain open during the roadway closure. Marked detours will be in place during this closure.

Howard Road SE Closure and Detour

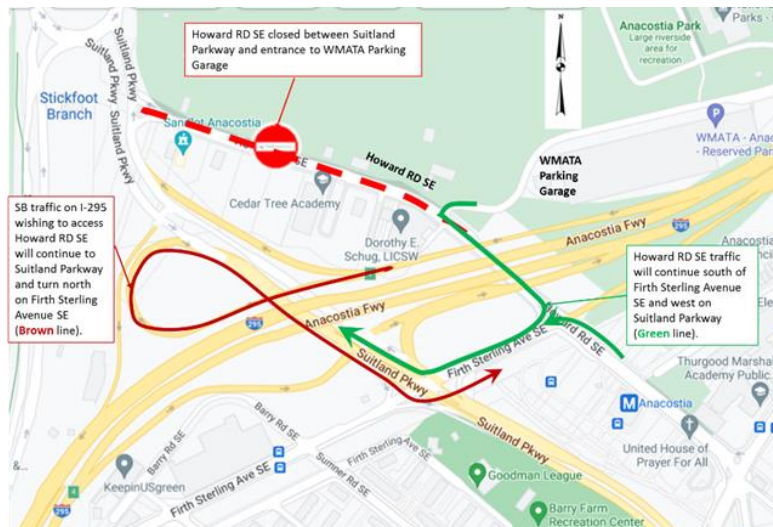

The intersection of Howard Road SE and Firth Sterling Avenue SE will be closed starting Friday night, September 23 at 7:00 p.m., extending through Monday morning, September 26 at 5:00 a.m. Right turn access from eastbound Howard Road SE to southbound Firth Sterling Avenue SE will be maintained. All sidewalks will remain open during the intersection closure. When the intersection is closed, all lanes will remain open on Suitland Parkway and South Capitol Street (between Firth Sterling Avenue SE and Suitland Parkway). Marked detours will be in place during this closure.

Howard Road SE/Firth Sterling Avenue SE Intersection Closure and Detour

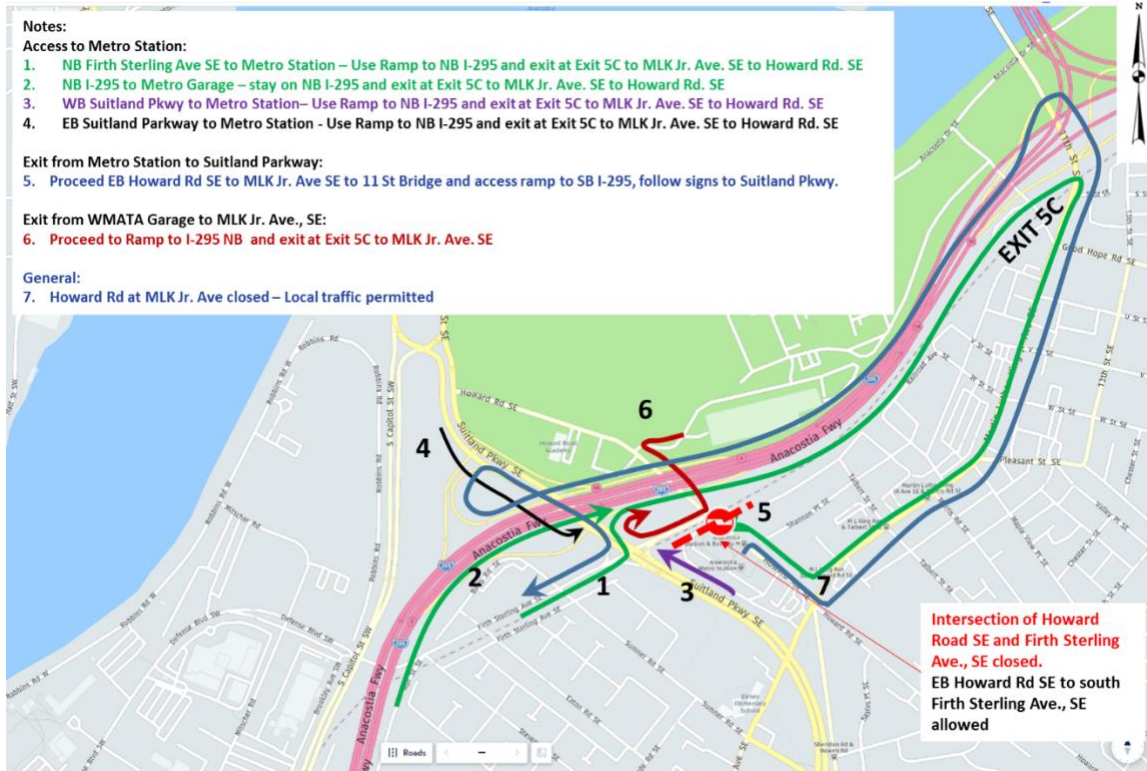

Due to the scheduled events at Nationals Park, lane closures will not occur during the following times:

- Saturday, September 24 – 3:00 p.m. to 12:00 a.m.

If any of these events are cancelled, lane closures will occur during the typical times. Additionally, any nighttime full roadway closures that are prohibited on these event days will take place in the event of an event cancellation.

These closures are necessary for construction activities associated with the South Capitol Street Corridor Project which includes construction of the New Frederick Douglass Memorial Bridge and the reconstruction of the I-295/Suitland Parkway interchange.

Please observe the posted speed limit and proceed through the construction area with caution. Pedestrians and cyclists are advised to stay alert and follow signage when traveling through this area.

For more information about the Frederick Douglass Memorial Bridge Project and to stay up-to-date on traffic related impacts and construction progress, please visit www.newfrederickdouglassbridge.com.

###

The mission of the District Department of Transportation (DDOT) is to enhance the quality of life for District residents and visitors by ensuring that people, goods, and information move efficiently and safely with minimal adverse impact on residents and the environment.

Follow us on [Twitter](#); like us on [Facebook](#) and visit the website at www.ddot.dc.gov to find out about DDOT's work across all eight wards of the District.. Visit goDCgo.com for more information on transportation options in the District.